

## SPECIFICATION FOR APPROVAL

CUSTOMER'S NAME : ATD

CUSTOMER'S MODEL NO. : Wireless Water Meter

CUSTOMER'S PART NO. : NIL

DESCRIPTION : R CHOKE

PART NO : SWM15-30uH

VERSION : A

Sample Qty. : \_\_\_\_\_

DATE : 2020.5.15

CUSTOMER'S APPROVED:

意见 APPROVED	签核 SIGNATURE

Prepared By	Checked By	Approved By
ZHANG	VINCENT	YANG

## Product Specification

### 1. 外形尺寸 (单位:mm)

Physical Dimensions UNIT = mm

	DIM	TOL
<b>A</b>	15.00	±0.3
<b>B</b>	3.00	±0.2
<b>C</b>	4.50	MAX
<b>D</b>	1.50	MIN.
<b>E</b>	1.70	MIN.
<b>F</b>	12.00	±1.0
<b>G</b>	3.80	±1.0

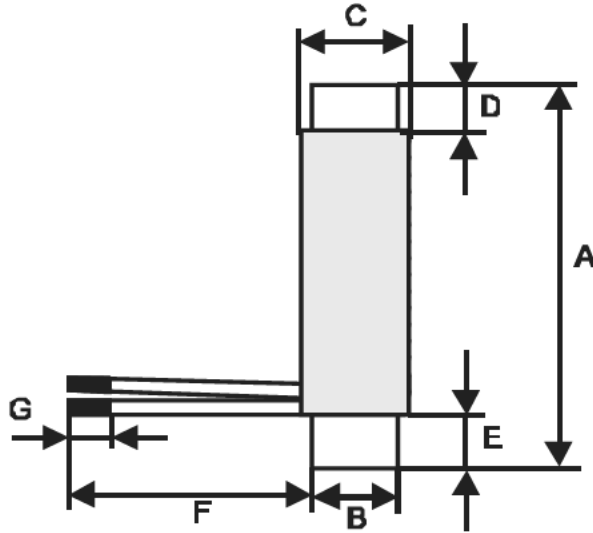

### 2. 电气特性

#### Electrical Characteristics

### 3. 绕线方法

#### WINDING METHOD

NO.	TEST ITEM	LIMIT	TEST CONDITION	TEST INSTRUMENT	绕组	圈数(Ts)	规格 SPEC.	胶带 TAPE	备注 REMARK
1	L(uH)	30 ±12%	10KHZ, 0.1V	VR116	N	45 REF	2UEW Φ0.05*10P		
2	DCR(Ω)	0.6 MAX.	25℃	CH502B					
3	Q Value	150 ~ 200		Special Instrument provided by customer					

### 4. 材料表

#### Bill of Material

No.	Item	Material name	Manufacturer	UL NO.	RoHS
1	WIRE	2UEW 155℃	HENG YA OR EQUIVALANT	E354216	YES
2	CORE	NiZn FERRITE	RIYUAN OR JACI OR EQUIVALANT		YES
3	TAPE	PZ 280	YA HUA OR EQUIVALANT	E165111	YES
3	VARNISH	1302B0H	KAIWEISI OR EQUIVALANT		YES
4	SOLDER	PURE	GOODWAY OR EQUIVALANT		YES
<b>PART NO.:</b>		<b>SWM15-30uH-R1</b>	<b>CUSTOMER'S MODEL NO.:</b>		<b>Wireless Water Meter</b>
<b>VERSION :</b>		<b>A</b>	<b>CUSTOMER'S PART NO. :</b>		<b>NIL</b>
<b>DATE :</b>		<b>2020.5.15</b>			

测试记录表  
TEST REPORT

日期:DATE: 2020.5.15

客户 CUSTOMER:	ATD			Part No.	SWM15-30uH				
客户料号 CUST. P/N:	NIL			版本/Version :	A				
测试设备Test instrument	VR116 CH502B			测试条件Test condition	10KHZ 0.1V				
测试项目:Test item:	L		DCR		A	B	C	D	E
单位:Unit	uH		$\Omega$		mm	mm	mm	mm	mm
规格:SPEC.	30±12%		0.6 MAX.						
1	32.000		0.480						
2	31.800		0.481						
3	30.800		0.480						
4	29.900		0.483						
5	32.000		0.482						
6									
7									
8									
9									
10									
MIN.	29.900		0.480						
MAX.	32.000		0.483						
R	2.100		0.003						
AVG.	31.300		0.481						
RESULT	PASS		PASS						

TESTER

ZHANG

CHECKED :

YANG