

D

C

B

A

D

C

B

A

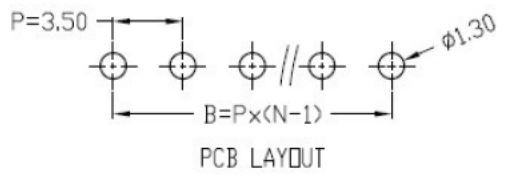
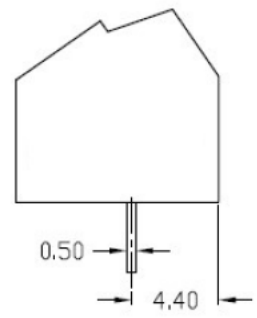
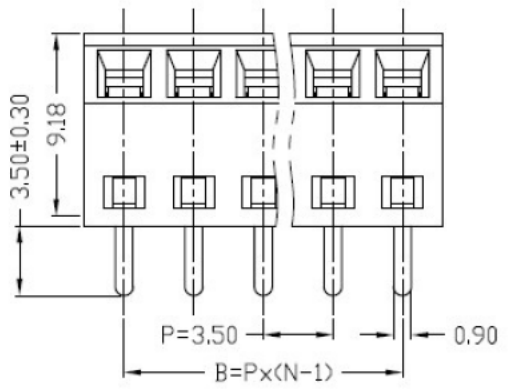
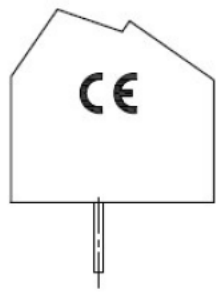
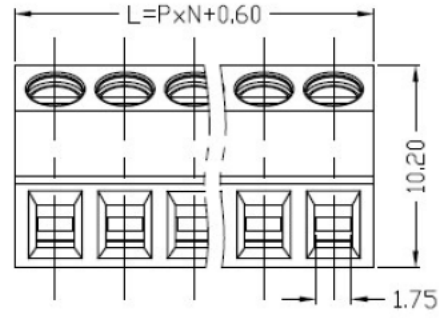

Technical Data		
Item	UL	IEC
Rated Electrical Parameters	300V/9A	130V/10A
Wire Range	26~16AWG	1,0mm <sup>2</sup>
Frequency Voltage	AC 2000V	
Rated Surge Voltage	4000V	
Insulation Resistance	DC500V 500MΩ above	
Contact Resistance	≤8mΩ	
Stripping Length	5mm	
Temperature	-40°C~+105°C	
Material and plating		
Housing	PA66 (UL94 V-0)	
Contact	Copper alloy, Sn plated	
Screws	Steel, Zn plated	
Cage	Copper alloy, Ni plated	

P=3,5mm, N for hole digits 02P~24P												
N	02P	03P	04P	05P	06P	07P	08P	09P	10P	11P	12P	13P
L	7,60	11,10	14,60	18,10	21,60	25,10	28,60	32,10	35,60	39,10	42,60	46,10
B	3,50	7,00	10,50	14,00	17,50	21,00	24,50	28,00	31,50	35,00	38,50	42,00
N	14P	15P	16P	17P	18P	19P	20P	21P	22P	23P	24P	
L	49,60	53,10	56,60	60,10	63,60	67,10	70,60	74,10	77,60	81,10	84,60	
B	45,50	49,00	52,50	56,00	59,50	63,00	66,50	70,00	73,50	77,00	80,50	

TOLERANCE		<b>SCHMID-M</b>
SCALE	UNIT mm	
DRAW Walter	DATE 5.6.2022	TITLE
CHECK Breeze	REV	<b>SM C09 33514S XX VS4</b>
		DESCRIPTION
		Spring Terminal Block RM3,5mm