

REV	MARK	ECN NO.	DESCRIPTION	NAME	DATE

**SPECIFICATIONS :**

**MATERIAL :**

- HOUSING MATERIAL: (1) GLASS FILLED PA66 (UL94V-0), (2) GLASS FILLED PA46 (UL94V-0), (3) GLASS FILLED PBT (UL94V-0).
- CONTACT MATERIAL: PHOSPHOR BRONZE  $\Phi 0.46\text{MM}$ .
- PLATING: GOLD PLATING  $\text{Fu}''-50\mu''$  OVER NICKEL.

**ELECTRICAL :**

- VOLTAGE RATING: 125Vac RMS .
- CURRENT RATING: 1.5AMP .
- CONTACT RESISTANCE: 30m $\Omega$  MAX .
- INSULATION RESISTANCE: 500M $\Omega$  MIN @ 500Vdc .
- DIELECTRIC WITHSTANDING VOLTAGE: 1000Vac RMS 50Hz 1MIN.

**MECHANICAL :**

- DURRABILITY : 750 CYCLES MIN.
  - INSETION FORCE: 2.2Kgf MAX.
  - RETENTION STRENGTH : 7.7Kgf MIN BETWEEN JACK AND PLUG.
- ENVIRONMENTAL :**
- TEMPRATURE : -40° C TO 85° C.

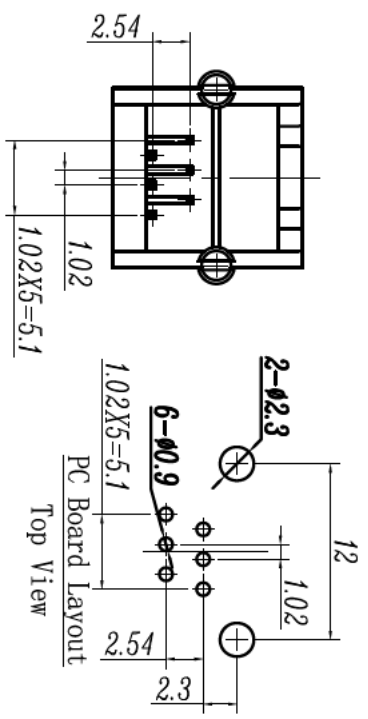
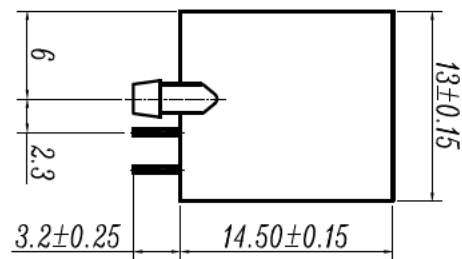
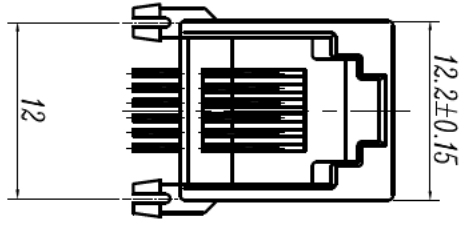

TOLERANCE UNLESS OTHERWISE SPEC		DESIGNED		TITLE : RJ11 6P6C TH1 TAB UP	
BASIC DIMENSION	TOLERANCE	CHECKED	SIZE	MM	PART NO. : SM C04 5521 66 A
.X	± 0.25		UNIT	MM	
.XX	± 0.10	STANDARDIZED	SCALE	1:1	
.XXX	± 0.05	APPROVED	WEIGHT		
ANGLES	± 0.5°		SHEET		
			REV	A	