

Notes:

1. Electrical Characteristics:

- 1.1 Contact Resistance: 20mΩ Max
- 1.2 Dielectric Withstanding Voltage: 600V AC(rms) for 1 Minute
- 1.3 Insulation Resistance: 1000mΩ Min
- 1.4 Current Rating: 3A
- 1.5 Voltage Rating: 250V AC rms

2. Environment Characteristics:

- 2.1 Temperature: -65°C ~ +125°C
- 2.2 Soler Temperature +260°C 3-5S Max

3. Materials:

- 3.1 Contact Materials: Copper Alloy
- 3.2 Contact Plating: Gold plate
- 3.3 Insulator Materials: PA46 / PA6T / PA9T, Black, UL94V-0 Standard PA6T

How to Order:

SM C02 2818 XX BD H=7,1 Package type -PEG

PEG - if omitted Without Fix/Peg

Package type

BC - Bag(with Cap) ; B - Bag(without Cap)
 TC - Tube(with Cap) ; T - Tube(without Cap)
 R - Reel(With Cap) ;

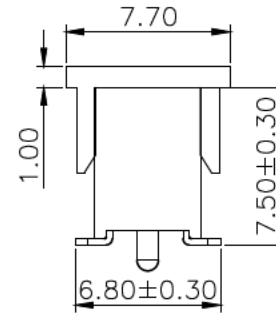
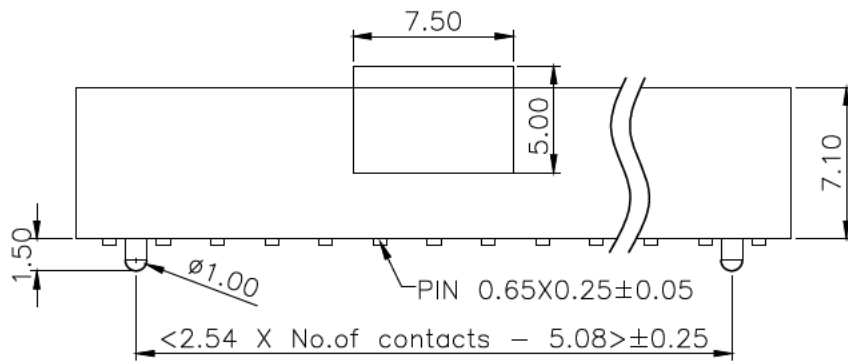
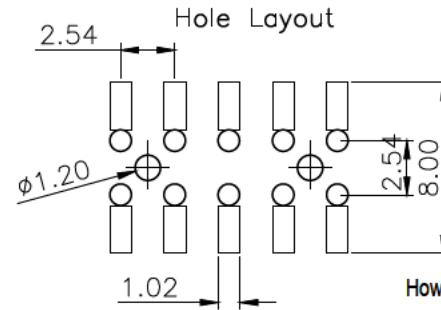
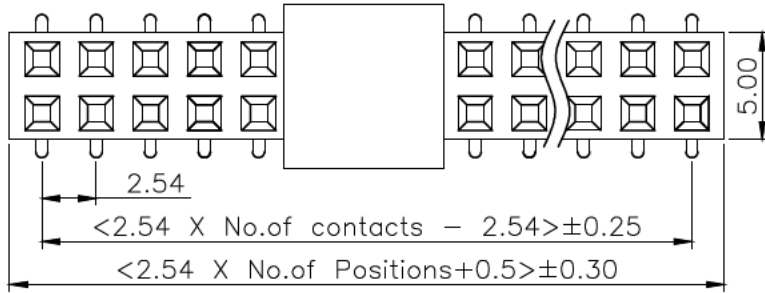
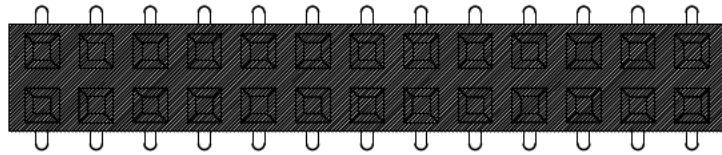

with Fix/Pegs

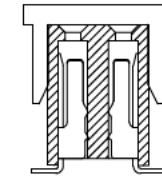

without Fix / Pegs

SCHMID-M

GENERAL TOLERANCE

X.* ± 5.0°	X. ± 0.30
.X* ± 3.0°	.X ± 0.25
.XX* ± 2.0°	.XX ± 0.15
.XXX* ± 1.0°	.XXX ± 0.10

DESIGN: Johnson

DATE: 2019.10.28

DWG. NO.: SM C02 2818 XX BD H=7,1

TITLE:

2.54mm Female header, Double Row
 SMT, with Fix or not , with Cap or not

CHECK:

DATE: 2019.11.01

PART NO.:

SM C02 2818 XX BD H=7,1mm

AUDIT:

DATE:

APPROVE:

DATE:

REV.: 01	UNIT.: mm	SCALE.: 1:1	PAGE.: 1/1	
-----------------	------------------	--------------------	-------------------	--