

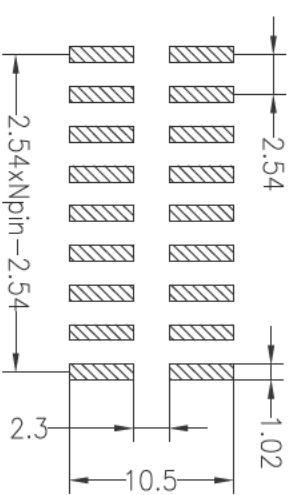

SPECIFICATIONS

Rated Current:3.0AMP
 Contact Resistance:20mΩ Max
 Withstand Voltage:1000V AC/DC
 Insulation Resistance:1000MΩ Min
 Operation Temperature:-40°C to +105°C

Contact Material:Brass
 Contact Plating:Au or Sn Over Ni
 Insulator Material:Polyester(UL94V-0)
 Standard: PA6T
 Max.Processing Temp: 230°C for 30-60 seconds
 (260°C for 10 seconds)

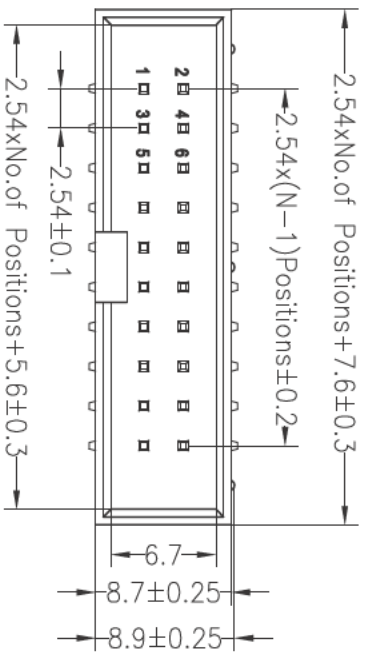

Recommended P.C.B Layout(Top Side)
 (PCB BOARD TOLERANCE±0.05)

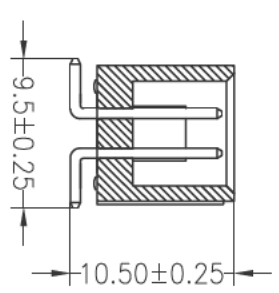
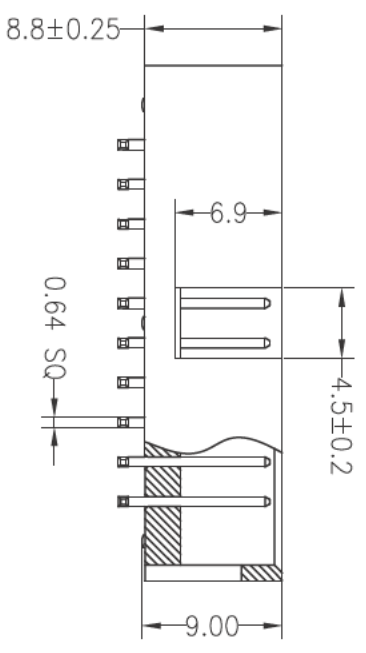

		OPERATION		DRAW		SCALE			
		X.X	±0.30	Walter		UNIT	FIT		
		X.XX	±0.20	19.09.21		SIZE	A4	PART NO.	
		X.XXX	±0.10	CHECK		SHEET	1/1	SM C02 2818 XX BD H=9,00mm	
A		NEW DRAWING		APPROVE		PROJ.		TITLE:	
REV		DATE	MODIFICATION DESCRIPTION	CHANGE	DIM	TOL	2.54mm Box Header		
1		2019.09.21							
2									
3									
4									
5									
6									
7									
8									
9									