

REV.	LOOKS.	DESCRIPTION	DATE	DRAWN
01		INITIAL RELEASE.	2007.09.15	

Specifications

Current Rating: 3Amp
 Insulation Resistance: 1000M Min. Ω
 Dielectric Withstanding: 600V AC
 Contact Resistance: 20m Max Ω
 Operating Temperature: -40°C to +105°C

Materials

Contact Material: Brass
 Insulation Material: Polyester, UL 94V-0
 Nylon 6T

All materials must be GP materials

Recommended P.C.Board
 Hole Layout

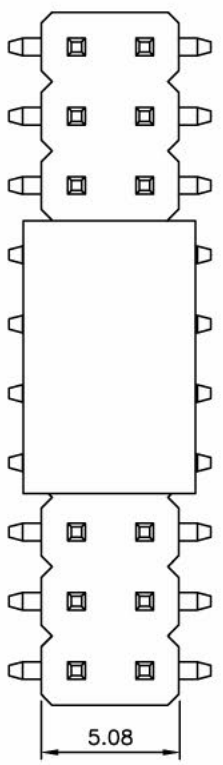
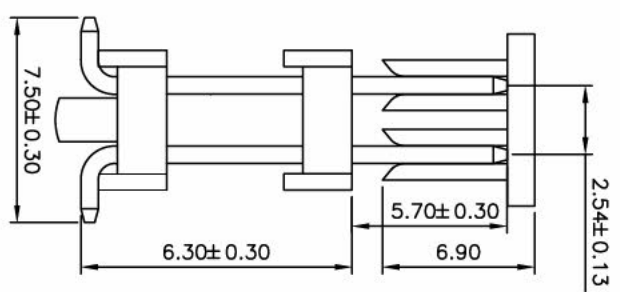
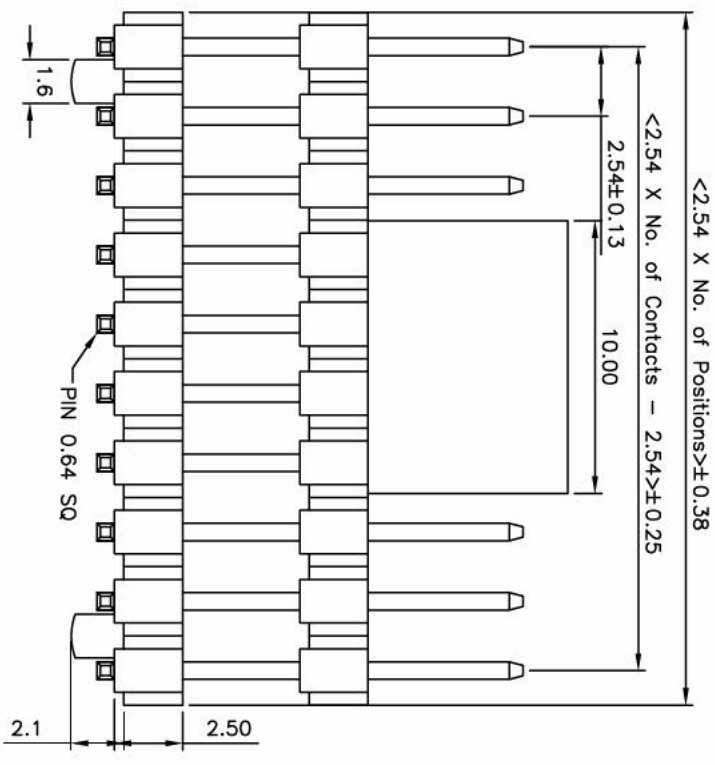
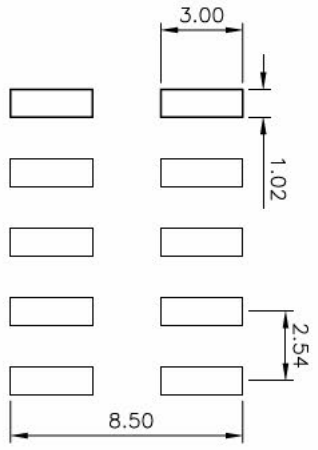

REV.	UNIT.	SCALE.	PAGE.	GENERAL TOLERANCE		DESIGN:	DATE:	PART NO. SM C02 2200 10 ED A.5.7 H.12.0 W/PEG/CAP	TITLE:
01	mm	1:1	1/1	X. ± 5.0°	X. ± 0.30	CHECKED:	DATE:		Pin Header SMD Double Row Double Insulator 6.3mm, RM 2.54*2.54mm
				X. ± 3.0°	X. ± 0.25	AUDITED:	DATE:		
				.XX ± 2.0°	.XX ± 0.15	APPROVED:	DATE:		
				.XXX ± 1.0°	.XXX ± 0.10				

A

B

C

D

E

F

1 2 3 4 5 6 7 8 9

A

B

C

D

E

F