

SM C02 2100 XX AS (C= ; E= ; A=) -Y

- XX - Contact No.: 1-40
- Y - Packaging: unmarked - bag
- T - Tube
- R - Reel Packing
- P - Pad + Tube Packing
- Q - Pad + Reel Packing

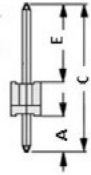

Example: SM C02 2100 20 AS; C=11,5mm; E=5,4mm
 = Header Pin Single Row and Single Insulator; RM:2,54mm
 20 Contacts; Dimension: C=11,5mm; E=5,4mm; A=3,0mm
 Packing: Bag

C=11,54mm; E=6,0mm; A=3,0mm

Material and Finish	Electrical Characteristics	Mechanical Characteristics
1. Housing: Thermoplastic (UL94V-0), Black. 2. Terminal: Sq. 0.64mm Copper Alloy, Gold Plating.	1. Current Rating: 30 Amp. Max. 2. Dielectric Withstand Voltage: 1000V AC RMS for 60seconds 3. Insulation Resistance: 1000M Ohm Min. at 100V DC.	1. Operating Temperature: -55°C~+105°C

APPD. Angel		TOLERANCE .0 ± 0.30 .00 ± 0.20 ANG. ±	PART NAME 2.54mm PIN HEADER SINGLE ROW XXP STRAIGHT TYPE FULL GOLD ROHS LOW-LEAD
DWG. Angel	SCALE UNIT M M	SIZE A 4	PART NO. SM C02 2100 XX AS C=11,54; E=6,0mm
DATE 2007/10/25	PAGE 1 OF 1	REV. A	