

REV.	LOOKS	DESCRIPTION	DATE	DRAWN
01			2011.04.30	

INITIAL RELEASE.

Specifications

Current Rating: 1Amp
 Insulation Resistance: 1000M Min. Ω
 Dielectric Withstanding: 300V AC
 Contact Resistance: 20m Max Ω
 Operating Temperature: -40°C to +105°C

Materials

Contact Material: Brass
 Insulation Material: Polyester, NYLON-6T
 UL 94V-0
 All materials must be GP

RECOMMENDED P.C.B LAYOUT

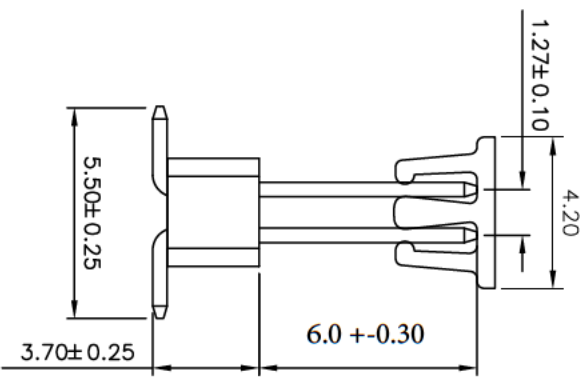
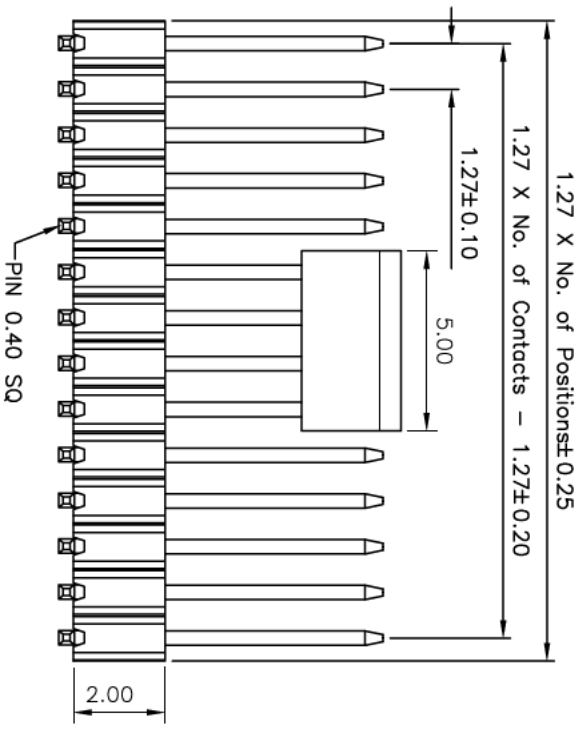
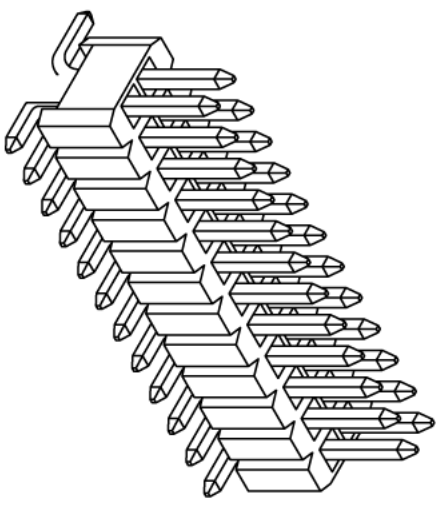
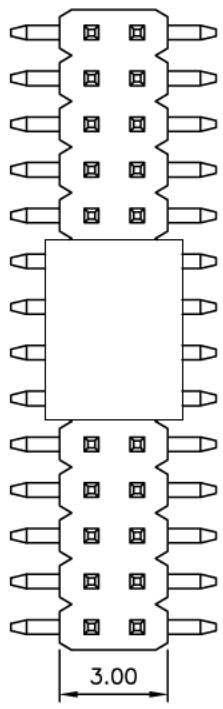
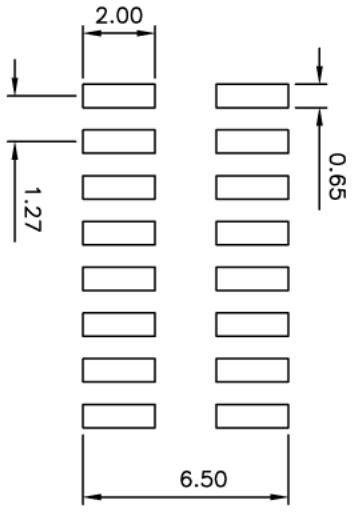

GENERAL TOLERANCE

X. ⁿ ± 5.0°	X.	± 0.30
X. ⁿ ± 3.0°	X	± 0.25
.XX ⁿ ± 2.0°	.XX	± 0.15
.XXX ⁿ ± 1.0°	.XXX	± 0.10

DESIGN:

CHECKED:	DATE:
AUDITED:	DATE:
APPROVED:	DATE:

PART NO.

SM C02 1271 XX BD: 1.27x1.27, E=6.0;
 S=5.5, With Cap REEL

TITLE:

Pin Header Dual Rows, Single Insulator, SMT, Packing T&R+CAP, XX = number of poles

REV.	UNIT.	SCALE.	PAGE.
01	mm	1:1	1/1

A

B

C

D

E

F

1 2 3 4 5 6 7 8 9

A

B

C

D

E

F