

N = No. of Contact

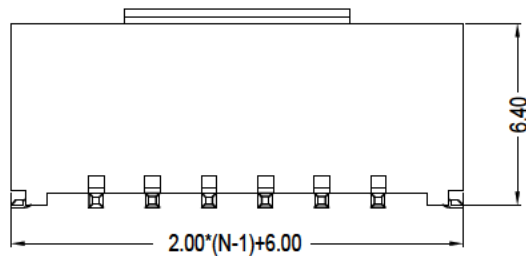

( Recommended P.C.B Layout )

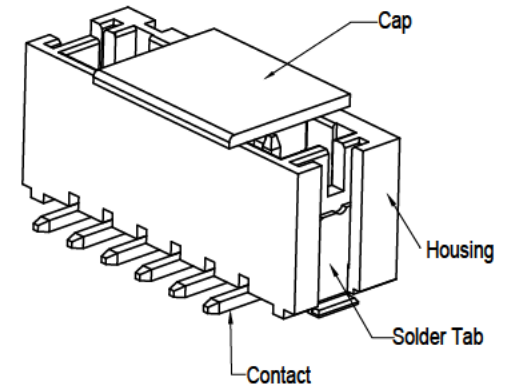
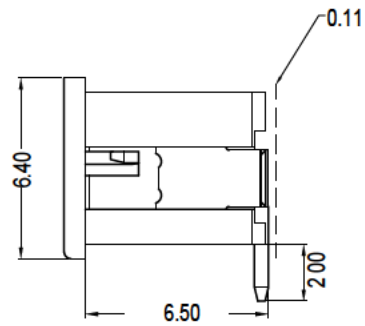
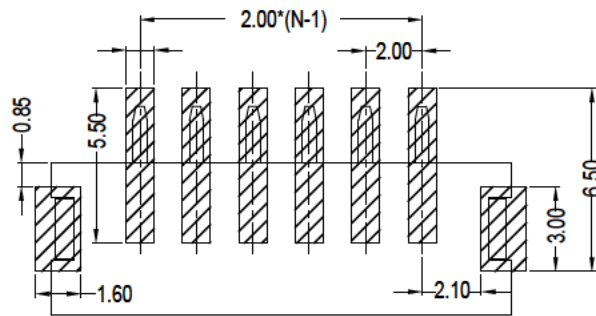

Notes:

1. Electrical Characteristics:
  1. 1 Contact Resistance: 20mΩ Max
  1. 2 Dielectric Withstanding Voltage: 600V AC(rms) for 1 Minute
  1. 3 Insulation Resistance: 1000mΩ Min
  1. 4 Current Rating: 2A
  1. 5 Voltage Rating: 100V AC rms
2. Environment Characteristics:
  2. 1 Temperature: -40°C ~ +105°C
3. Materials:
  3. 1 Contact Materials: Copper Alloy
  3. 2 Contact Plating: Tin plated over Nickle
  3. 3 Insulator Materials: PA9T , UL94V-0

**SCHMID-M**

**GENERAL TOLERANCE**

X.* ± 5.0°	X. ± 0.30
.X* ± 3.0°	.X ± 0.25
.XX* ± 2.0°	.XX ± 0.15
.XXX* ± 1.0°	.XXX ± 0.10

**DESIGN:** Walter

**DATE:** 2020.02.28

**DWG. NO.:**

**TITLE:**

**CHECK:** Brizz

**DATE:** 2020.03.02

**PART NO.:**

Wire to Board Connector 2.00mm, SMT  
Top Entry

**AUDIT:**

**DATE:** 2020.03.02

**SM C02 2020 XX AZ W**

**APPROVE:**

**DATE:** 2020.03.02

<b>REV.:</b> 01	<b>UNIT.:</b> mm	<b>SCALE.:</b> 1:1	<b>PAGE.:</b> 1/1	
--------------------	---------------------	-----------------------	----------------------	--