

1 2 3 4 5 6 7 8

A

A

Standard	UL	VDE
Rated voltage	300V	250V
Rated current	10A	12A
Withstanding voltage	AC2000V/1Min	
Ambient temperature	-30°C~+120°C	
Pitch	5.00 / 10.00 mm(.100")	
Poles	2P , 3P ---24 poles	
Housing	PBT,UL94V-0	
Contact	Brass, Tin Plated	

B

B

C

C

SM C09 2505 XX S

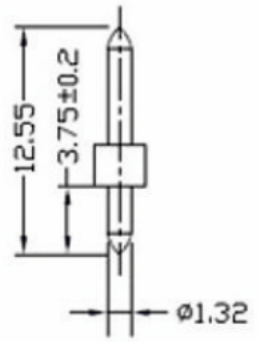
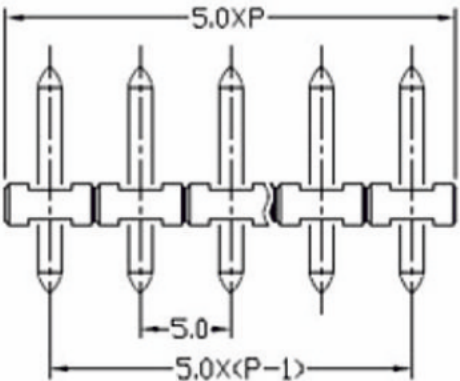

D

D

E

E

F

F

SM C09 2505 XX R

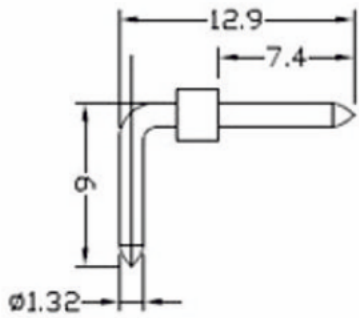
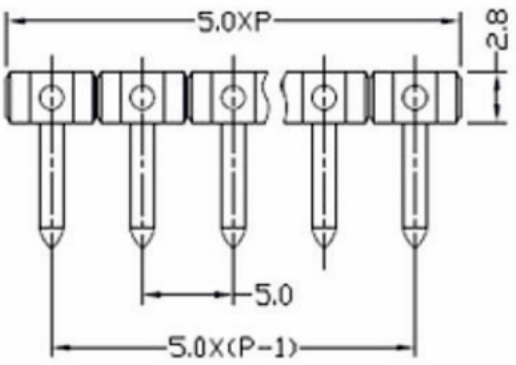

G

G

H

H

<p>RoHS Compliant</p>		<p><b>SCHMID-M</b></p>	
<p>APPD.</p>		<p>TOLERANCE</p>	<p>PART NAME</p>
<p>DWG.</p>	<p>SCALE</p>	<p>0 ± 0.30 .00 ± 0.20 ANG. ±</p>	<p>Header for Wire Protector Terminal Block, RM 5.00mm, Black</p>
<p>Braun</p>	<p>UNIT</p>	<p>SIZE.</p>	<p>XX: Nr. of Poles Y: S Straight, R Right Angle</p>
<p>DATE</p>	<p>M M</p>	<p>A 4</p>	<p>PART NO.</p>
<p>09.06.2012</p>	<p>PAGE</p>	<p>REV.</p>	<p>SM C09 2505 XX Y</p>
	<p>1 OF 1</p>	<p>A</p>	

1 2 3 4 5 6 7 8