

1 2 3 4 5 6 7 8

P=7.62mm, (N for hole digits), (Significant Digits): 02P~24P

N	02P	03P	04P	05P	06P	07P	08P	09P	10P	11P	12P	13P
L	13.62	21.24	28.86	36.48	44.10	51.72	59.34	66.96	74.58	82.20	89.82	97.44
B	7.62	15.24	22.86	30.48	38.10	45.72	53.34	60.96	68.58	76.20	83.82	91.44
N	14P	15P	16P	17P	18P	19P	20P	21P	22P	23P	24P	
L	105.06	112.68	120.30	127.92	135.54	143.16	150.78	158.40	166.02	173.64	181.26	
B	99.06	106.68	114.30	121.92	129.54	137.16	144.78	152.40	160.02	167.64	175.26	

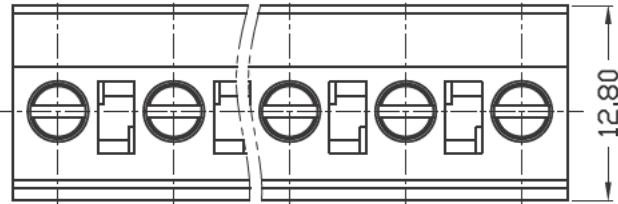

UL	IEC
300V/16A	400V/20A
28~12AWG	0.2~2.5mm <sup>2</sup>
AC 2500V	
6000V	
DC500V 5COMΩ above	
≤8nΩ	
7mm	
-40°C~+105°C	

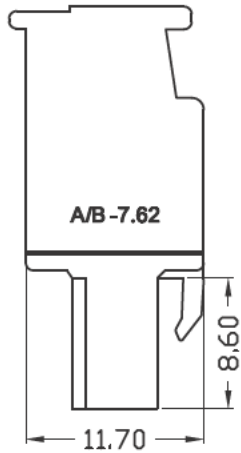
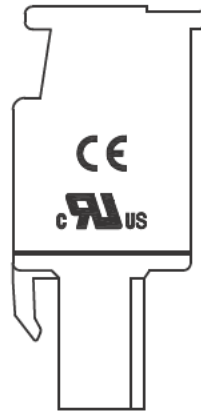
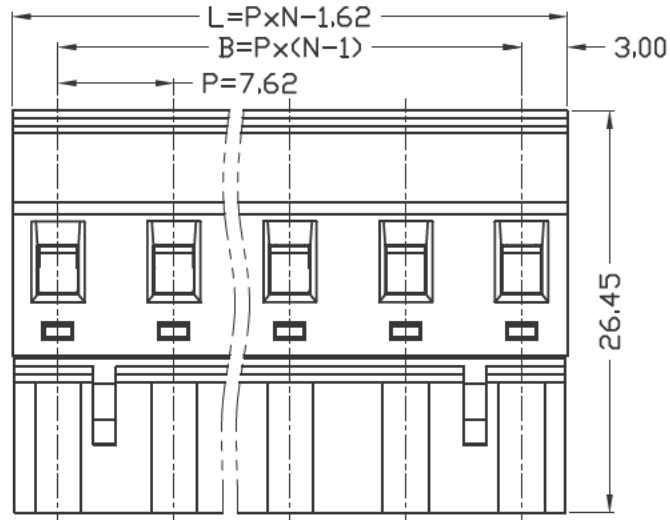

Housing: PAL66 (UL94 V-0)  
 Contact: Copper alloy, Ni plated  
 Screws: Steel, Zn plated  
 Cage: Copper alloy, Ni plated

D  
C  
B  
A

D  
C  
B  
A

1 2 3 4 5 6 7 8

TOLERANCE		
SCALE	UNIT mm	
DRAW Walter	DATE 5.4.2019	TITLE SM C09 0765 XX YOC
CHECK Vanda	REV	DESCRIPTION Pluggable Terminal Block RM7,62mm