

ROHS COMPLIANT

1.27mm Micro Match Box Header IDC

SPECIFICATION

Current Rating: 1.0Amp
 Insulation Resistance: 1000MΩ min
 Contact Resistance: 20MΩ max
 Withstand Voltage: 500V AC/DC
 Operating Temperature: -40°C to +105°C
 Contact Material: Phosphor Bronze
 Contact Plating: Au Over Ni
 Insulator Material: PBT+30%GF UL 94V-0 Red

XX: NR. PIN
Y: A-TYPE 1
Y: B-TYPE 2

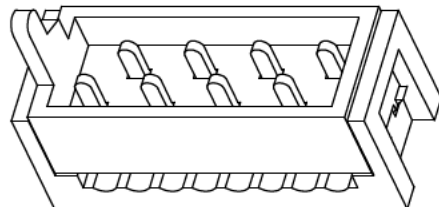
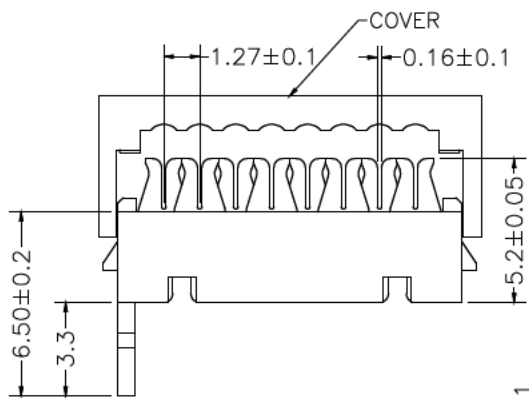
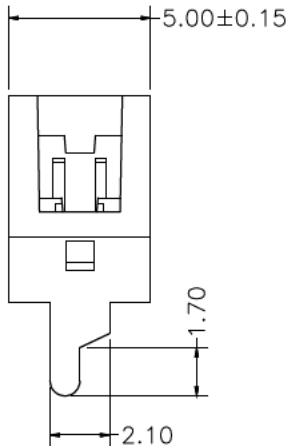

W/O BUMP Type1

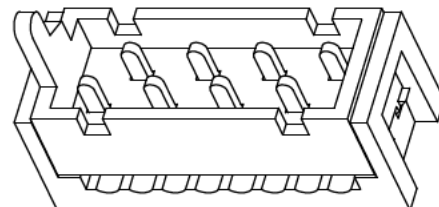
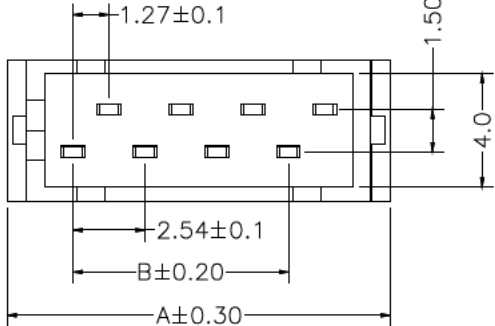

WITH BUMP Type2

| POLES | DIM. A | DIM. B | QTY/Tube |
|-------|--------|--------|----------|
| 4 | 8.45 | 2.54 | 68 |
| 6 | 10.99 | 5.08 | 52 |
| 8 | 13.53 | 7.62 | 42 |
| 10 | 16.07 | 10.16 | 36 |
| 12 | 18.61 | 12.7 | 31 |
| 14 | 21.15 | 15.24 | 27 |
| 16 | 23.69 | 17.78 | 24 |
| 18 | 26.23 | 20.32 | 22 |
| 20 | 28.77 | 22.86 | 20 |
| 26 | 36.39 | 30.48 | 16 |

Unless Otherwise specified tolerance
 X:±0.35
 X.X:±0.25
 X.XX:±0.20
 X.XXX:±0.15

SCALE: 2:1 UNIT: mm

DRAWN: Peter
 CHECKED: Mark



TITLE:
 1.27mm Micro Match Box Header IDC

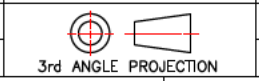

DRAWING NO: SM C02 3135 XX Y
 PRODUCT NO:

| REV | DESCRIPTION | DATE |
|-----|-----------------------|----------|
| 1 | Add option of plating | 10-08-28 |

