

Notes:

1. Electrical Characteristics:

- 1.1 Contact Resistance: 20mΩ Max
 - 1.2 Dielectric Withstanding Voltage: 300V AC(ms)for 1 Minute
 - 1.3 Insulation Resistance: 1000mΩ Min
 - 1.4 Current Rating: 1.5A
 - 1.5 Voltage Rating: 125V AC rms
- 2. Environment Characteristics:**
- 2.1 Temperature: -65°C ~ +125°C
 - 2.2 Solder Temperature +260°C 3-5S Max
- 3. Materials:**
- 3.1 Contact Materials: Copper Alloy
 - 3.2 Contact Plating: Gold plate
 - 3.3 Insulator Materials: PA6T / PA9T, Black, UL94V-0

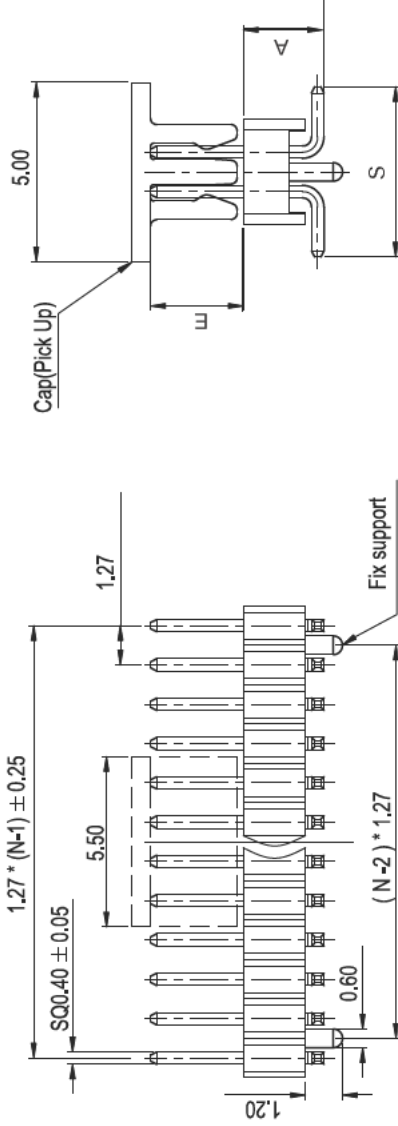

N: No. of Contacts / 2

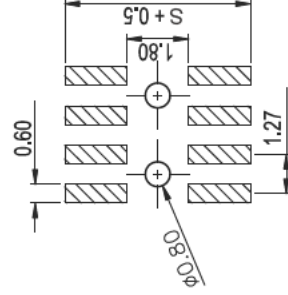
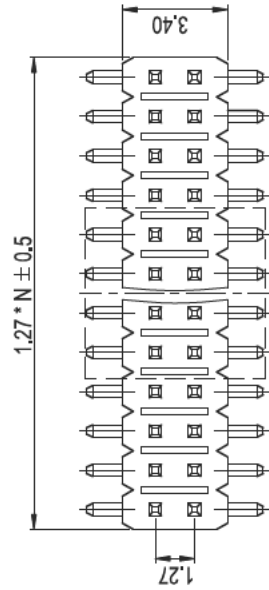

RECOMMEND PCB LAYOUT

Ordering Information

SM C02 1271 XX BD (E= A= S=)-Fix-Packing

SM C02 1271 : Series

XX : Number of Pin (total)

BD : Double Row, SMD

E= A= S= : Dimensions

F : Fix Support - if omitted = Without

packing : Packing - if omitted = Bag

T = Tube

TC = Tube+CAP

T&R = Tape&Reel+Cap

SCHMID-M

REV.: 01 UNIT: mm SCALE: 1:1 PAGE: 1/1

GENERAL TOLERANCE	
X.' ± 5.0°	X. ± 0.30
.X' ± 3.0°	.X ± 0.25
.XX' ± 2.0°	.XX ± 0.15
.XXX' ± 1.0°	.XXX ± 0.10

DESIGN:	DATE:
	2020.02.28
CHECK:	DATE:
	2020.03.02
AUDIT:	DATE:
	2020.03.02
APPROVE:	DATE:
	2020.03.02

DWG. NO.:

TITLE:

1.27mm Pin header, Double Row, Straight SMT, with Fix or not, with Cap or not

PART NO.: SM C02 1271 XX BD (E= A= S=)-Fix-Packing