



Rotary Switches

K1 Metal Knobs



- Robust solid-aluminum design (RoHS compliant)
- For D-shape and round shafts
- Glossy anodized surface, scratch resistant, electrically non conducting and available in many colours
- Customized designs on request available

Explanation:

∅ d = Shaft diameter
 L = Shaft length
 P = Front panel thickness

Secure shaft attachment ensured
 with setscrew tightening

Shaft diameter Order number

∅ d Natural / Silver Black

*** Standard Product**

Recommended dimensions for **Encoders**

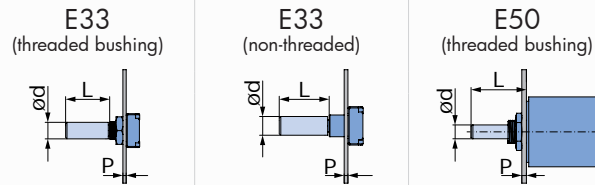

Shape

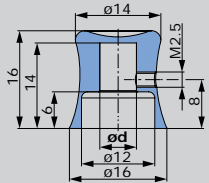

Weight: 3,6g

3mm	K1-SH-S30	K1-SH-B30
3,18mm (1/8")	K1-SH-S32	K1-SH-B32
4mm	K1-SH-S40	K1-SH-B40
* 6mm	K1-SH-S60	K1-SH-B60
6,35mm (1/4")	K1-SH-S64	K1-SH-B64

d = 6mm L = 7,8mm P = Min. 0,8mm Max. 3mm	d = 6mm L = 7mm P = Min. 0,8mm Max. 3,5mm at L=7mm P _{max} = depending on L	Combination not possible
--	---	--------------------------

Shaper

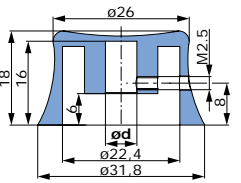

Weight: 14,5g

3mm	K1-SR-S30	K1-SR-B30
3,18mm (1/8")	K1-SR-S32	K1-SR-B32
4mm	K1-SR-S40	K1-SR-B40
* 6mm	K1-SR-S60	K1-SR-B60
6,35mm (1/4")	K1-SR-S64	K1-SR-B64

d = 6mm L = 7,8mm P = Min. 0,8mm Max. 3mm	d = 6mm L = 7mm P = Min. 0,8mm Max. 3,5mm at L=7mm P _{max} = depending on L	d = 6mm L = 14,3mm P = Min. 2mm Max. 5mm
--	---	---

Dimple

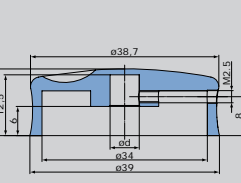

Weight: 16,8g

3mm	K1-DM-S30	K1-DM-B30
3,18mm (1/8")	K1-DM-S32	K1-DM-B32
4mm	K1-DM-S40	K1-DM-B40
* 6mm	K1-DM-S60	K1-DM-B60
6,35mm (1/4")	K1-DM-S64	K1-DM-B64

d = 6mm L = 7,8mm P = Min. 0,8mm Max. 3mm	d = 6mm L = 7mm P = Min. 0,8mm Max. 3,5mm at L=7mm P _{max} = depending on L	d = 6mm L = 14,3mm P = Min. 2mm Max. 5mm
--	---	---

Pure

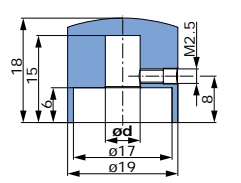

Weight: 8,9g

3mm	K1-PR-S30	K1-PR-B30
3,18mm (1/8")	K1-PR-S32	K1-PR-B32
4mm	K1-PR-S40	K1-PR-B40
* 6mm	K1-PR-S60	K1-PR-B60
6,35mm (1/4")	K1-PR-S64	K1-PR-B64

d = 6mm L = 7,8mm P = Min. 0,8mm Max. 3mm	d = 6mm L = 7mm P = Min. 0,8mm Max. 3,5mm at L=7mm P _{max} = depending on L	d = 6mm L = 14,3mm P = Min. 2mm Max. 5mm
--	---	---

Robot

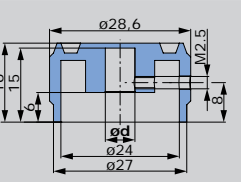

Weight: 12,2g

3mm	K1-RB-S30	K1-RB-B30
3,18mm (1/8")	K1-RB-S32	K1-RB-B32
4mm	K1-RB-S40	K1-RB-B40
* 6mm	K1-RB-S60	K1-RB-B60
6,35mm (1/4")	K1-RB-S64	K1-RB-B64

d = 6mm L = 7,8mm P = Min. 0,8mm Max. 3mm	d = 6mm L = 7mm P = Min. 0,8mm Max. 3,5mm at L=7mm P _{max} = depending on L	d = 6mm L = 14,3mm P = Min. 2mm Max. 5mm
--	---	---

Space

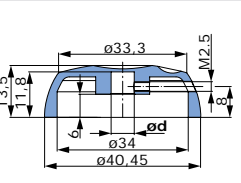

Weight: 15,2g

3mm	K1-SC-S30	K1-SC-B30
3,18mm (1/8")	K1-SC-S32	K1-SC-B32
4mm	K1-SC-S40	K1-SC-B40
* 6mm	K1-SC-S60	K1-SC-B60
6,35mm (1/4")	K1-SC-S64	K1-SC-B64

d = 6mm L = 7,8mm P = Min. 0,8mm Max. 3mm	d = 6mm L = 7mm P = Min. 0,8mm Max. 3,5mm at L=7mm P _{max} = depending on L	d = 6mm L = 14,3mm P = Min. 2mm Max. 5mm
--	---	---

Cone

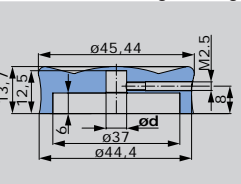
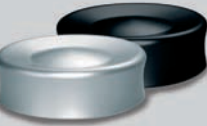

Weight: 36,2g

3mm	K1-CN-S30	K1-CN-B30
3,18mm (1/8")	K1-CN-S32	K1-CN-B32
4mm	K1-CN-S40	K1-CN-B40
* 6mm	K1-CN-S60	K1-CN-B60
6,35mm (1/4")	K1-CN-S64	K1-CN-B64

d = 6mm L = 7,8mm P = Min. 0,8mm Max. 3mm	d = 6mm L = 7mm P = Min. 0,8mm Max. 3,5mm at L=7mm P _{max} = depending on L	d = 6mm L = 14,3mm P = Min. 2mm Max. 5mm
--	---	---

Medic

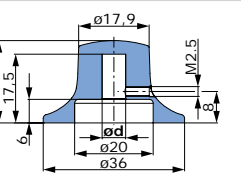



Weight: 16,8g

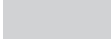

3mm	K1-MD-S30	K1-MD-B30
3,18mm (1/8")	K1-MD-S32	K1-MD-B32
4mm	K1-MD-S40	K1-MD-B40
* 6mm	K1-MD-S60	K1-MD-B60
6,35mm (1/4")	K1-MD-S64	K1-MD-B64

d = 6mm L = 7,8mm P = Min. 0,8mm Max. 3mm	d = 6mm L = 7mm P = Min. 0,8mm Max. 3,5mm at L=7mm P _{max} = depending on L	d = 6mm L = 14,3mm P = Min. 2mm Max. 5mm
--	---	---

Standard colours

Anodized natural „Aluminum-silver“	
Black	

Special colours

Bright red	
Real gold	
Green	
Turquoise blue	
Light blue	
Dark blue	

Additional colours available on request

Content of standard packing

- 20pcs. for Shaper, Robot, Space, Dimple, Cone, Medic
- 40pcs. for Shape or Pure
- 1 pc. set screw M2,5x3mm per knob
- 1 pc. setscrew-wrench WS 1,3mm



20pcs. for Shaper, Robot, Space, Dimple, Cone, Medic



40pcs. for Shape or Pure

Spare parts

Description	Quantity	Order number
Setscrew-wrench WS 1,3mm	1 pc.	K1-HEXKEY
Set screw M2,5x3mm	1 pc.	5404-31

Additional information

Note: Tighten the set screw carefully, max. torque 0,3Nm

Elma - Your Solution Partner for complete solutions

Elma Case

Steel- or
Aluminum construction

Elma Handles

Elma Front Panels

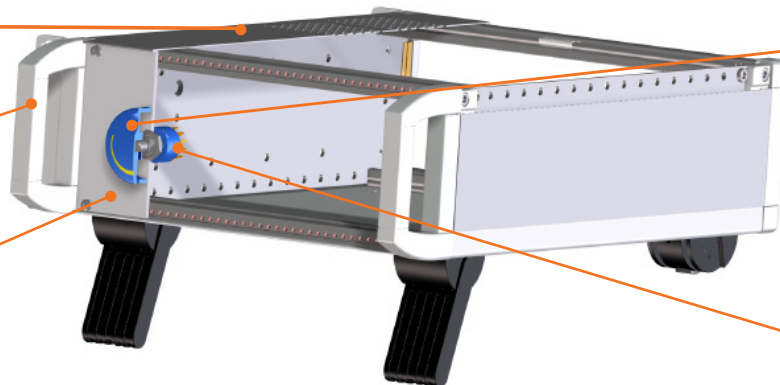

Elma Knobs

Metal- and
plastic knobs

Elma Rotary Switches

Coded switches,
Encoders,
Selector switches

**ELMA Electronic AG**

Hofstrasse 93, Postfach
CH-8620 Weizikon
Phone +41 44 933 41 11
Fax +41 44 933 42 15
sales@elma.ch

**ELMA Electronic
France SA**

ZA du Buisson Rond
F-38460 Villemoirieu
Phone +33 4 37 06 21 10
Fax +33 4 37 06 21 19
sales@elma-electronic.fr

**ELMA Electronic Inc.**

44350 Grimmer Blvd.
Fremont, CA 94538
Phone +1 510 656 3400
Fax +1 510 656 3783
sales@elma.com

ELMA Bustronic Corp.

44350 Grimmer Blvd.
Fremont, CA 94538
Phone +1 510 490 7388
Fax +1 510 490 1853
sales@elmabustronic.com

**Optima EPS Corp. - an Elma
Company**

1775 MacLeod Drive
Lawrenceville, GA 30043
Phone +1 770 496 4000
Fax +1 770 496 4041
sales@elma.com

ACT/Technico

760 Veterans Circle
Warminster, PA 18974-3531
Phone +1 215 956 1200
Fax +1 215 956 1201
sales@acttechnico.com

**ELMA Electronic GmbH**

Stuttgarter Strasse 11
D-75179 Pforzheim
Phone +49 7231 97 34 0
Fax +49 7231 97 34 97
info@elma.de

**ELMA Electronic
Israel Ltd.**

34, Modi'in St.
Sgula I.Z., Petach-Tikva, 49271 IL
Phone +972 3 930 5025
Fax +972 3 931 3134
sales@elma.co.il

**ELMA Electronic UK Limited**

Solutions House
Fraser Road, Priory Business Park
Bedford, MK44 3BF
Phone +44 1234 838 822
Fax +44 1234 836 650
sales@elma-mektron.co.uk

**ELMA Electronic
Romania SRL**

Chisoda, DN 59 Km 8 + 550 m
307221 Judet Timis
Phone +40 256 306 046
Fax +40 256 249 820
info@elma.ro

**ELMA Electronic
(China) Co., Ltd.**

8F, 355, Fu Te Road (West 1)
Wai Gao Qiao Free Trade Zone
Pudong District
Shanghai, 200131, China
Phone +86 21 5866 5908
Fax +86 21 5866 5918
sales@elmachina.com

**Elma Asia Pacific Pte Ltd**

115-A Commonwealth Drive
#03-14 Tanglin Halt Industrial Estate
149596 Singapore
Phone +65 6479 8552
Fax +65 6479 8662
sales.elmaap@elma.com

Your local solution partner:



www.atd-elektronik.cz
www.atd-shop.com

K-4920-2 Edition 01/12 E

www.elma.com

ELMA
Your Solution Partner