

Product description **M12-A integrated socket, Contacts: 5, shieldable, with shield plate, dip-solder, IP68, UL**

Area **M12-A series 713**
Order number **99 3442 458 05**

Illustration



Conductor layout

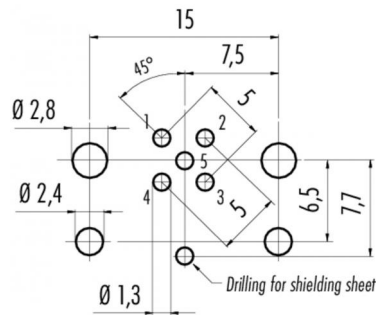

Scale drawing

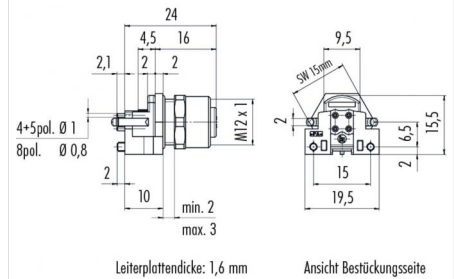

Contact arrangement

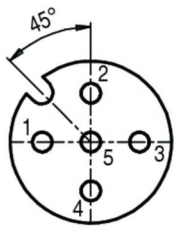

| | X | Y |
|---|-------|-------|
| 1 | -2,50 | 0,00 |
| 2 | 0,00 | 2,50 |
| 3 | 2,50 | 0,00 |
| 4 | 0,00 | -2,50 |
| 5 | 0,00 | 0,00 |

You can find the assembly instructions on the next page.

Technical data

General values

| | |
|--------------------------|-------------------|
| Connector design | integrated socket |
| Connector locking system | screw |
| Termination | dip-solder |
| Upper limit temperature | 85 °C |
| Lower limit temperature | - 40 °C |
| Customs tariff number | 85369010 |

Cable data

| | |
|------------|----|
| Approval 1 | UL |
|------------|----|

Electrical values

| | |
|---------------------------|-------------------------------|
| Rated current (40 °C) | 4 A (3 A UL) |
| Rated voltage | 60 V |
| Rated impulse voltage | 1500 V |
| Pollution degree | 3 |
| Overvoltage category | II |
| Insulating material group | III |
| Insulation resistance | > 10 ⁸ Ω |
| EMC compliance | shieldable, with shield plate |
| Degree of protection | IP68 |
| Mechanical operation | > 100 Mating cycles |

Material

| | |
|-----------------------|---------------|
| Contact material | CuSn (bronze) |
| Contact plating | Au (gold) |
| Contact body material | PA |

Product description **M12-A integrated socket, Contacts: 5, shieldable, with shield plate, dip-solder, IP68, UL**

Area **M12-A series 713**
Order number **99 3442 458 05**

Assembly instructions / Panel cut-out

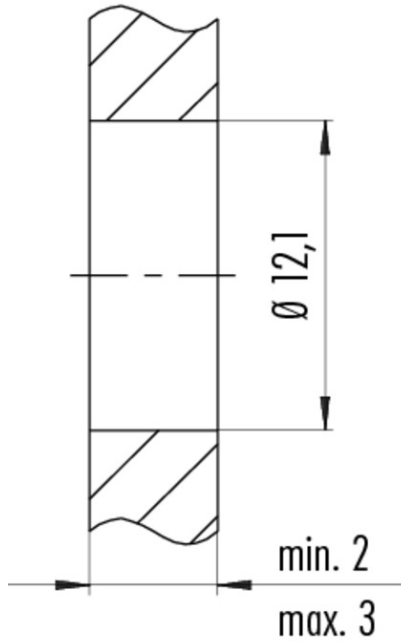

Anzugsdrehmoment / Tightening torque
M12 x 1 6,25 Nm

| | |
|---------------------|--|
| Product description | M12-A integrated socket, Contacts: 5, shieldable, with shield plate, dip-solder, IP68, UL |
| Area | M12-A series 713 |
| Order number | 99 3442 458 05 |

Security notices

The connector must not be connected or separated under load. Non-observance and incorrect use can result in personal injury.

The connectors are designed for use in plant, control system and electrical equipment. The end user is responsible for checking whether the connectors are suitable for use in other applications.

Connectors with degree of protection IP 67 and IP 68 are not suitable for use under water. When used outdoors, the connectors must be separately protected against corrosion. For further information about IP degrees of protection refer to 'Technical support' in the Download Centre.